



Submersible motor

Optimix 2G 55-75

Optimix 2G 90-75



Powerfull
Innovative Design
High efficiency

Application

Dry matter content up to 12 %
Substrate temperature up to 55°C
pH-value 6.5 - 8.2

Propeller

3-blade high efficiency propeller, dynamically balanced

Optimix 2G 55-75	5,5 kW	LT 1400-G6	75 rpm
Optimix 2G 90-75	9,0 kW	LT 1400	75 rpm

Standard painted, optional hardened steel

Motor

Power: 5.5 / 9.0 kW
400 V, 50 Hz, other voltages on request
Protection class IP 68, up to 10 m submergence
PTC thermistors 130°C for thermal protection
Power factor
Own oil circulation, turbine oil

Guide mast connection

Guide mast support with 4 rollers for smooth height adjustment

Depending version, available for 100 / 120 / 150 mm square mast

Special sizes on request

Gear / Bearing

Robust, two stage planetary gear
Reduction ration $i = 19.6$
Mechanical seal SiC/SiC
2 tapered-roller bearings to absorb the axial forces
Hardened steel spline shaft, $\varnothing 50$ mm
Separate oil fill with long life gear oil
Oil change interval 12,000 operation hours

Corrosion protection

Ductile cast iron housing (GGG40)
Agitator has an two component epoxy coating
Agitator is galvanically isolated from the guide mast

Cable

Pressed-on cable gland
Standard length 10 m
Cable $7 \times 4 + 2 \times 1,5$ mm², $\varnothing 20$ mm
Microbe resistant
Strain relief 800 N

Ex-zone

Authorized for Ex-Zone 2
ATEX Classification $\text{CE} \text{ II 3G Ex nAck IIA T3 Gc}$

Control box (optional)

Soft start or frequency converter

Submersible motor

Optimix 2G 55-75

Optimix 2G 90-75

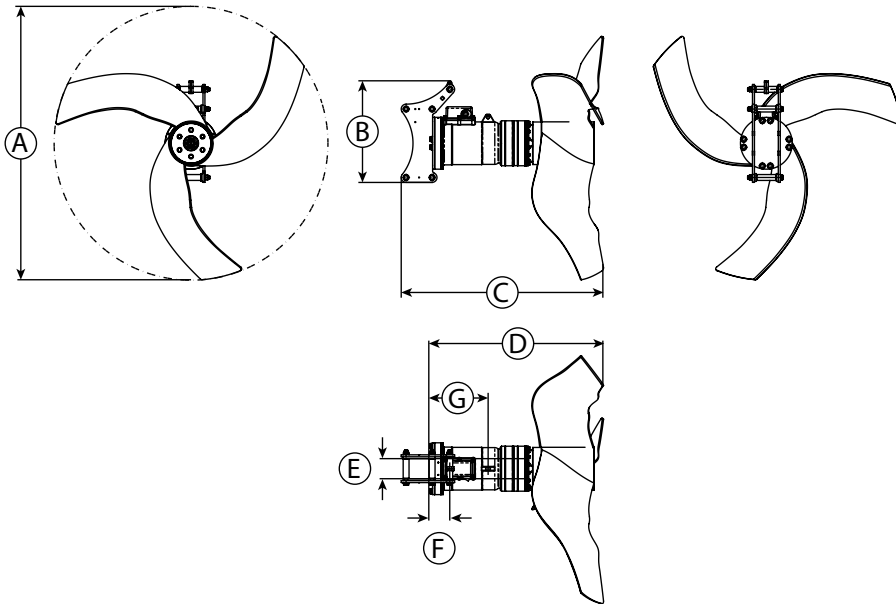

Dimensions										
Type	A [mm]	B [mm]	C [mm]	D [mm]	E [mm]	F [mm]	G [mm]			
2G 55-75	1,400	520	1,200	1,000	100 / 120 / 150	105	300			
2G 90-75										

Technical data												
Type	Rated Power [kW]	Rated Voltage [V]	Full load current [A]	Frequency [Hz]	Power factor cos ϕ	Gear reduction ratio	Propeller speed [rpm]	Propeller diameter [mm]	Axial force [kN]	Flow velocity [m/s] *	Pumping rate [m ³ /min]	Weight approx. [kg]
2G 55-75	5.5	400	10.7	50	0.83	19.6	75	1,400	2.6	1.8	150	200
2G 90-75	9.0	400	18	50	0.86	19.6	75	1,400	2.9	1.8	150	200

Subject to technical changes

* measured in water and 1.2 m distance